

TOSHIBA Bipolar Linear Integrated Circuit Silicon Monolithic

TA4303F

Down Converter for BS/CS Tuner IC

Description

The TA4303F is a monolithic IC to down-convert the L-band (900~2150 MHz) signal for the satellite tuners. It's integrated circuits that perform the mixer/oscillator function. They have double-balanced mixer, local oscillator, IF amplifier, OSC buffer amplifier and prescaler buffer amplifier circuits.

Features

- Single chip full band solution, compatible with digital and analog transmissions.
- Single 5 V power supply operation
- Full band constant conversion Gain and Noise Figure
- Local oscillator output circuit for PLL
- Low Phase Noise local oscillator

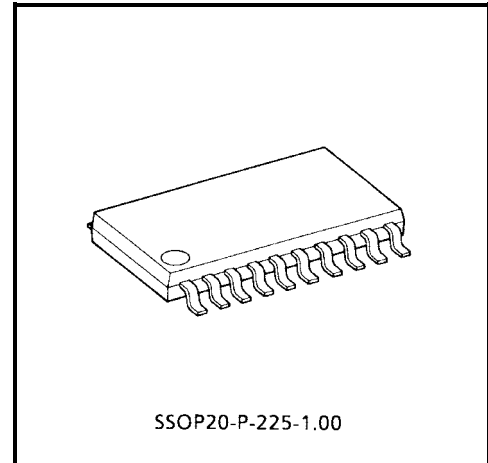

Weight: 0.17 g (typ.)

000707EBA1

- TOSHIBA is continually working to improve the quality and reliability of its products. Nevertheless, semiconductor devices in general can malfunction or fail due to their inherent electrical sensitivity and vulnerability to physical stress. It is the responsibility of the buyer, when utilizing TOSHIBA products, to comply with the standards of safety in making a safe design for the entire system, and to avoid situations in which a malfunction or failure of such TOSHIBA products could cause loss of human life, bodily injury or damage to property.
In developing your designs, please ensure that TOSHIBA products are used within specified operating ranges as set forth in the most recent TOSHIBA products specifications. Also, please keep in mind the precautions and conditions set forth in the "Handling Guide for Semiconductor Devices," or "TOSHIBA Semiconductor Reliability Handbook" etc..
- The TOSHIBA products listed in this document are intended for usage in general electronics applications (computer, personal equipment, office equipment, measuring equipment, industrial robotics, domestic appliances, etc.). These TOSHIBA products are neither intended nor warranted for usage in equipment that requires extraordinarily high quality and/or reliability or a malfunction or failure of which may cause loss of human life or bodily injury ("Unintended Usage"). Unintended Usage include atomic energy control instruments, airplane or spaceship instruments, transportation instruments, traffic signal instruments, combustion control instruments, medical instruments, all types of safety devices, etc.. Unintended Usage of TOSHIBA products listed in this document shall be made at the customer's own risk.
- The products described in this document are subject to the foreign exchange and foreign trade laws.
- The information contained herein is presented only as a guide for the applications of our products. No responsibility is assumed by TOSHIBA CORPORATION for any infringements of intellectual property or other rights of the third parties which may result from its use. No license is granted by implication or otherwise under any intellectual property or other rights of TOSHIBA CORPORATION or others.
- The information contained herein is subject to change without notice.

Pin Connection Function Block Diagram

Marking

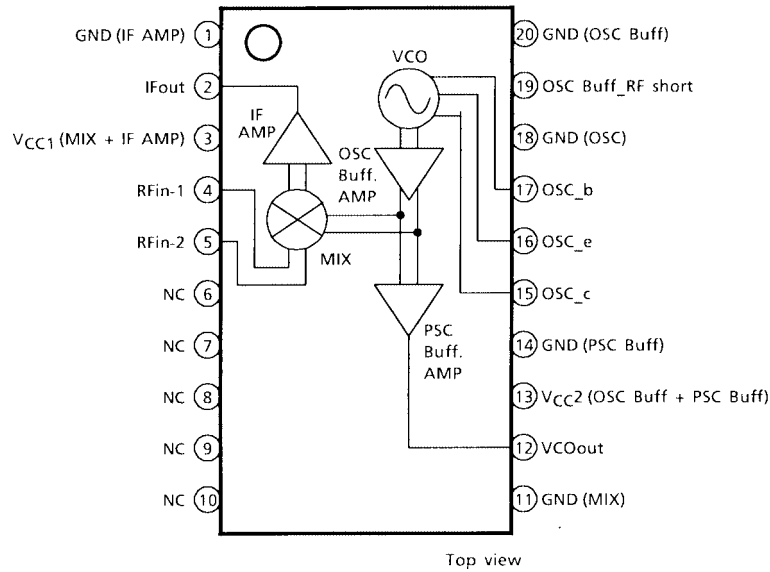

Package : SSOP20-P-225, 1.0mm pitch

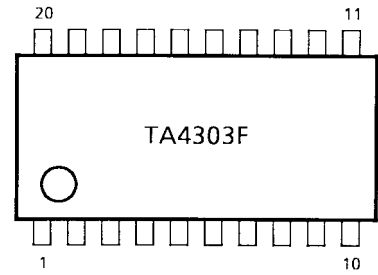

Caution

This device is electrostatic sensitive.

Explanation

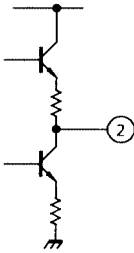
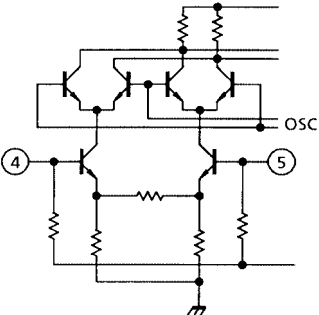
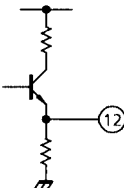
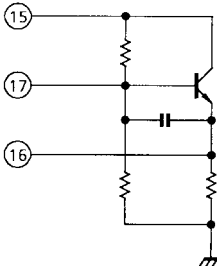
Pin No.	Pin Name	Pin Voltage	Explanation	Equivalent Circuit
1	GND (IF Amp)	0	GND pin for IF Amp.	—
2	IF out	2.2	IF output pin.	
3	VCC1 (MIX + IF Amp)	5.0	Supply voltage for MIX + IF Amp.	—
4	RFin-1	1.7	RF input pin.	
5	RFin-2	1.7	RF input pin.	
6	NC	—	—	—
7	NC	—	—	—
8	NC	—	—	—
9	NC	—	—	—
10	NC	—	—	—
11	GND (MIX)	0	GND pin for MIX.	—
12	VCOout	2.0	OSC output pin.	
13	VCC2 (OSC Buff + PSC Buff)	5.0	Supply voltage pin for OSC Buff + PSC Buff.	—
14	GND (PSC Buff)	0	GND pin for PSC Buff.	—
15	OSC-c	5.0	OSC collector pin, supply voltage pin.	
16	OSC-e	1.8	Emitter pin for OSC.	
17	OSC-b	2.6	Base pin for OSC.	

Pin No.	Pin Name	Pin Voltage	Explanation	Equivalent Circuit
18	GND (OSC)	0	GND pin for OSC.	—
19	RF GND (OSC Buff)	1.4	RF GND pin.	<p>The diagram shows a differential pair of transistors. The emitters are connected to a common point which is biased by a resistor connected to a supply rail. The bases are biased by a resistor network. The collectors are connected to a supply rail through resistors. One collector output is labeled 'MIX' and is connected to pin 19. There are also input resistors on the left side of the circuit.</p>
20	GND (OSC Buff)	0	GND pin for OSC Buff.	—

Maximum Ratings (Ta = 25°C)

Characteristic	Symbol	Rating	Unit
Supply voltage	V _{CC}	6	V
Total power dissipation	P _D (Note1)	1100	mW
Operating temperature	T _{opr}	-20~85	°C
Storage temperature	T _{stg}	-45~150	°C

Note 1: 100 cm² × 1.6 t (Cu layer area: 36%) on glass epoxy resins.

Recommended Operating Range

Characteristic	Symbol	Rating	Unit
Supply voltage	V _{CC} (Amp)	4.75~5.25	V
Supply voltage	V _{CC} (OSC)	4.75~5.25	V
Input frequency range	f _{in}	900~2150	MHz
IF Input frequency range	f _{IF}	350~550	MHz

Electrical Characteristics (Ta = 25°C) (Note 2)

Characteristics	Symbol	Test Circuit	Test Condition	Min	Typ.	Max	Unit
Supply current	I _{CC} (Total)	1	V _{CC} = 5 V, No RF input	61	74	87	mA
Conversion gain	G _c	1	f _{in} = 1.6 GHz, f _{IF} = 400 MHz	14	18	25	dB
Noise figure	NF	1	f _{in} = 1.6 GHz, f _{IF} = 400 MHz	—	15	22	dB
Saturation output	P _O (sat)	1	f _{in} = 1.6 GHz, f _{IF} = 400 MHz	5	10	—	dBmW
Third-order intercept	IP3	1	f _{in} = 1.596 GHz, 1.6 GHz f _{IF} = 400 MHz, 404 MHz	12	17	24	dBmW
Posc	POSC	1	f _{LO} = 2.0 GHz	-14	-8	—	dBmW

Note 2: All electrical characteristics measured in Supply Voltage 5.0 V (Amp, OSC, OSC Buffer)

Reference Characteristic (Note 3)

Characteristics	Symbol	Test Circuit	Test Condition	Typ.	Unit
Supply current	I _{CC} (Amp)	1	V _{CC} = 5 V, No RF input	36	mA
Supply current	I _{CC} (OSC)	1	V _{CC} = 5 V, No RF input	38	mA

Note 3: All electrical characteristics measured in Supply Voltage 5.0 V (Amp, OSC, OSC Buffer)

Test Circuit

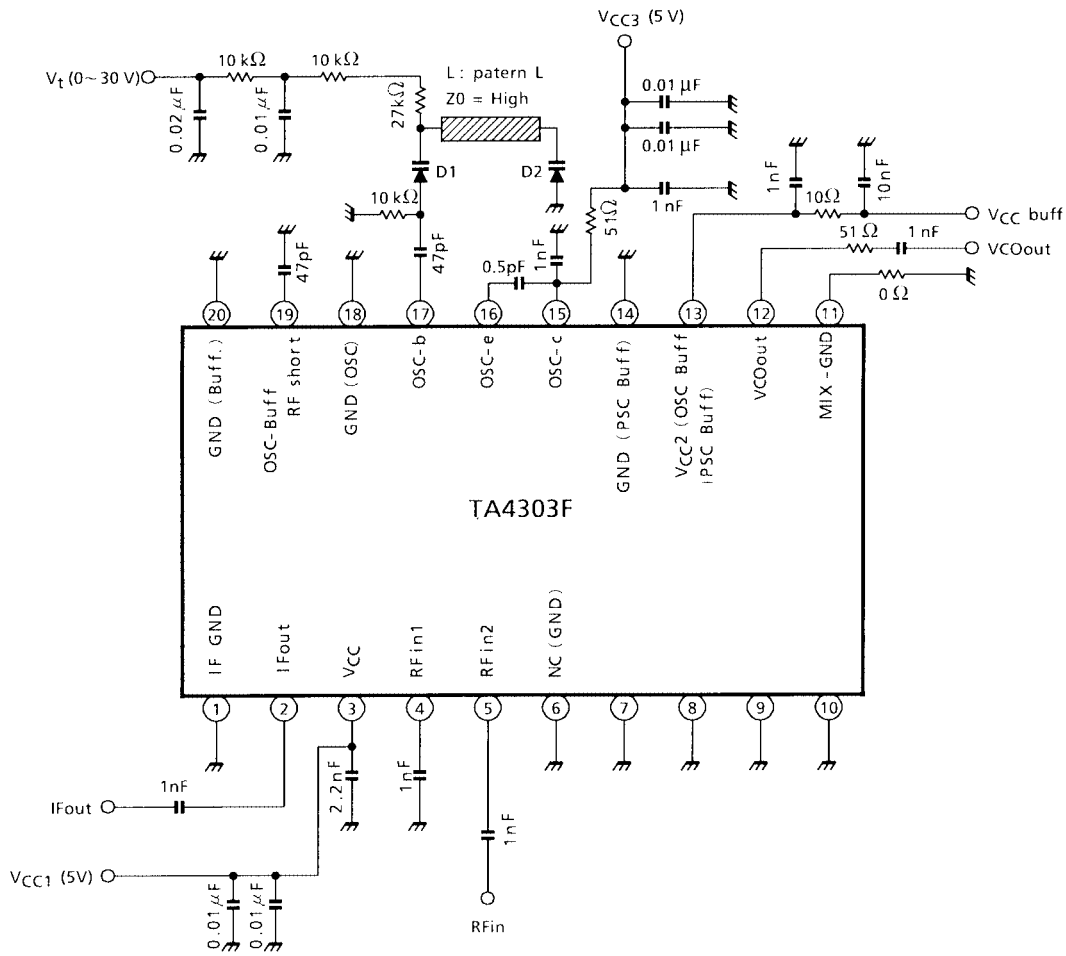

Notice

The circuits and measurements contained in this document are given only in the context of as examples of applications for these products.

Moreover, these example application circuits are not intended for mass production, since the high-frequency characteristics (the AC characteristics) of these devices will be affected by the external components which the customer uses, by the design of the circuit and by various other conditions.

It is the responsibility of the customer to design external circuits which correctly implement the intended application, and to check the characteristics of the design.

TOSHIBA assume no responsibility for the integrity of customer circuit designs or applications.

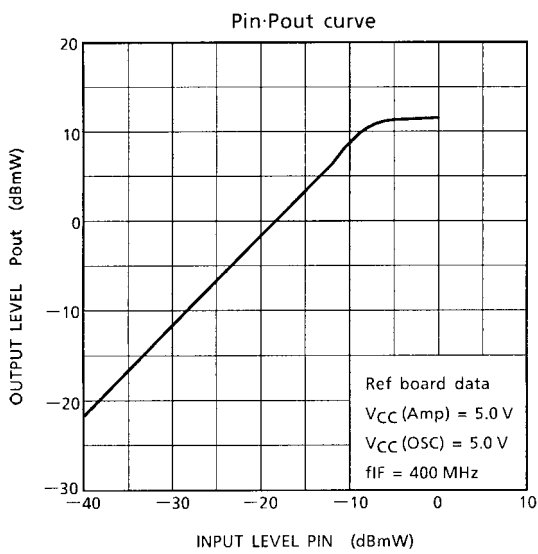
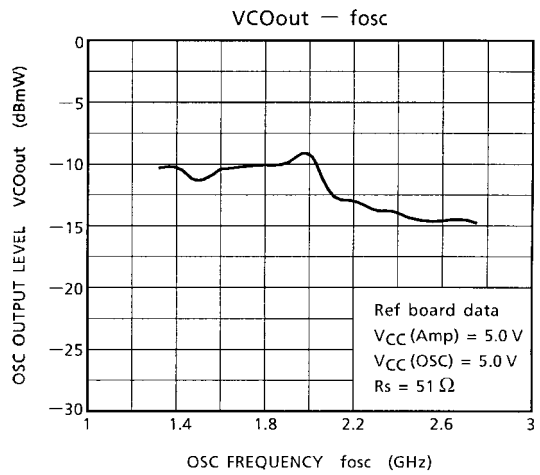
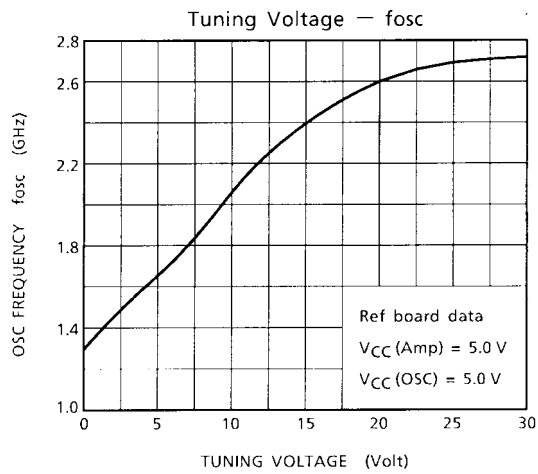
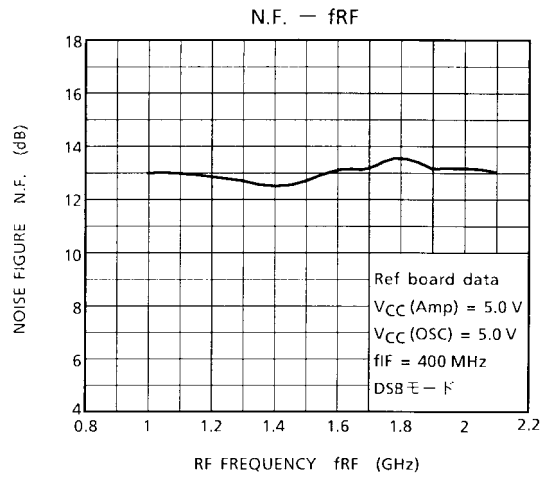
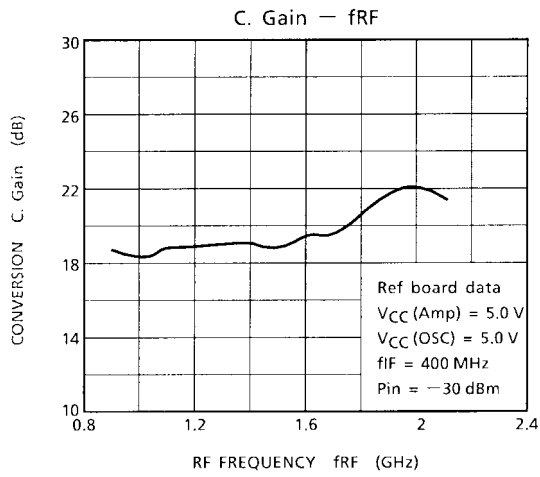

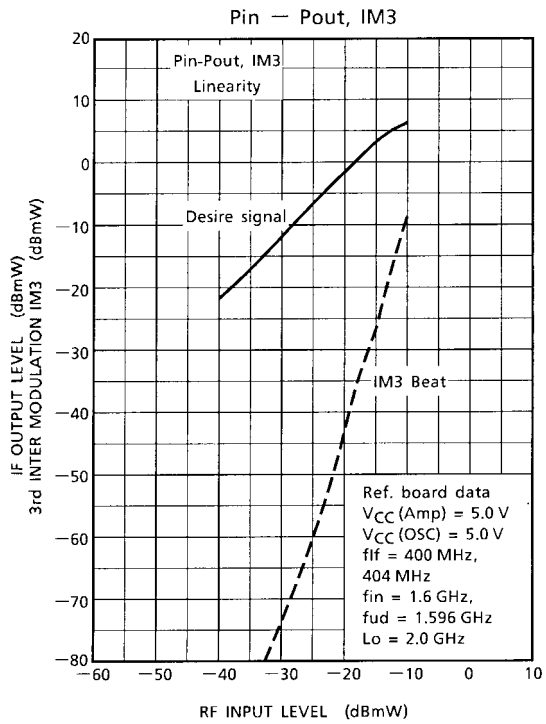

Package Dimensions

SSOP20-P-225-1.00

Unit : mm

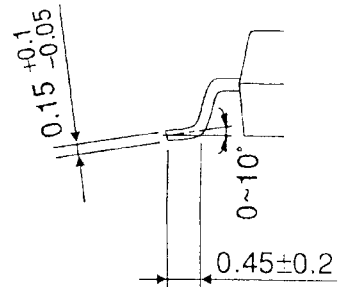
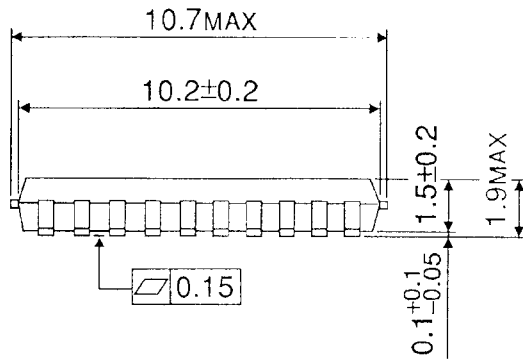
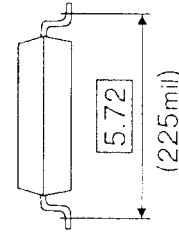
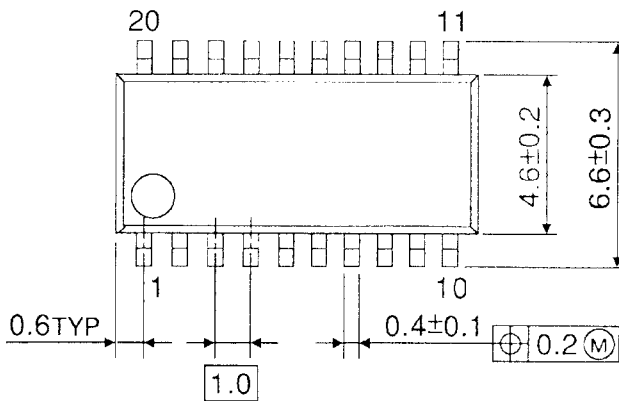

Weight : 0.17 g (Typ.)